

4.3m WIDE STERILE SECTION OF LAND ADJACENT TO
EXISTING R168 TO ALLOW FOR FUTURE PROVISION OF 1.8m
FOOTPATH, 2.0m CYCLE PATH AND 0.5m BUFFER AS
REQUESTED BY LOUTH COUNTY COUNCIL

This drawing should not be scaled. Dimensions to be verified on site.
Any discrepancies should be referred to the Engineer prior to work being put in hand.
This drawing is the property of Waterman Moylan Consulting Engineers Limited and is
issued on the condition that it is not copied, reproduced, retained or disclosed to any unauthorized person, either
wholly or in part without the consent in writing of
Waterman Moylan Consulting Engineers Limited
Block 5, Eastpoint Business Park, Dublin D03 H3F4 Ireland
T: 01 864 8900

- NOTES:
- DO NOT SCALE. USE FIGURED DIMENSIONS ONLY.
 - THIS DRAWING IS TO BE READ IN CONJUNCTION WITH ALL OTHER RELEVANT ARCHITECTURAL AND ENGINEERING DRAWINGS.

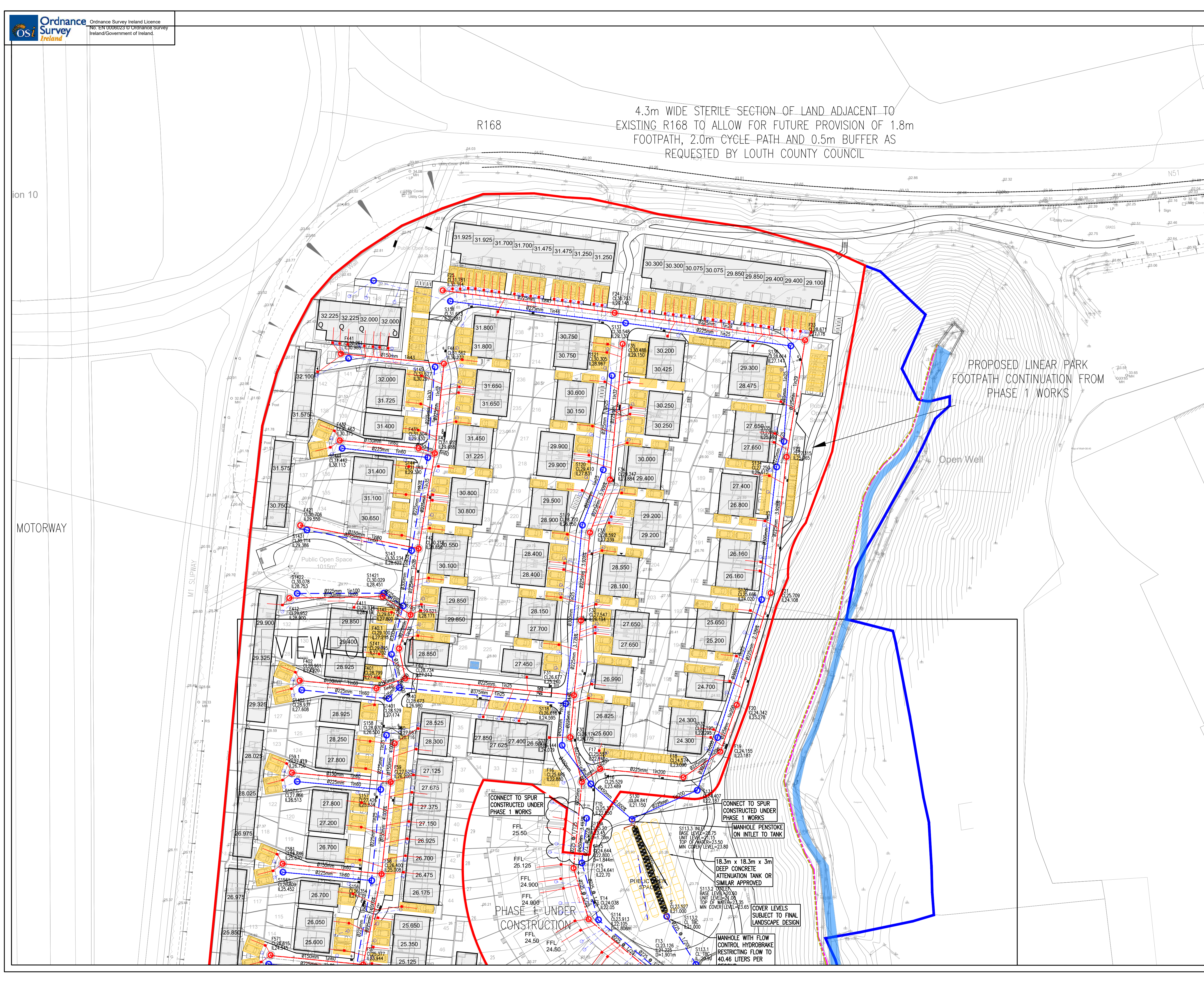

LEGEND

- F12 CL22.556 L20.694 D=1.862m: PROPOSED FOUL WATER MANHOLE AND SEWER WITH 0.5m OFFSET INDICATED DASHED
- S113 CL20.515 D=2.063m: PROPOSED STORM WATER MANHOLE AND SEWER WITH 0.5m OFFSET INDICATED DASHED
- 100# IC: INDIVIDUAL PRIVATE FOUL WATER DRAIN WITH INSPECTION CHAMBER 1.2m DEEP
- G ---: PROPOSED GULLY AND 150# GULLY PIPE, DOUBLE GULLY AT LOW POINTS
- : PROPOSED RISING MAIN
- : EXISTING FOUL SEWER
- : EXISTING STORM PIPE

A	09/05/23	ISSUED FOR PLANNING	NS	MD
Rev	Date	Description	By	CHK
Amendments				
Project				
PROPOSED RESIDENTIAL DEVELOPMENT AT OLD SLANE ROAD, DROGHEDA, CO. LOUTH				
Title				
PHASE 2 DRAINAGE LAYOUT AND LEVELS SHEET 2 OF 2				
Client				
LAGAN HOMES TULLYALLEN LTD.				

waterman moylan

BLOCK 5, EASTPOINT BUSINESS PARK, ALFIE BYRNE ROAD, DUBLIN D03 H3F4 IRELAND. Tel: (01) 864 8900
Email: info@waterman-moylan.ie www.waterman-moylan.ie

Status: **PLANNING**

Designed By	NS	Approved	MD	Planning Ref	23-067
Drawn By	NS	Date	APRIL 2024	Scale	@ A1 1:500
Project	Originator	Volume	Level	Type	Number
OSR - WMC - ZZ - ZZ-DR - C - 3202					A

ion 10

MOTORWAY

M1 SLIPWAY

VIEW

CONNECT TO SPUR CONSTRUCTED UNDER PHASE 1 WORKS

CONNECT TO SPUR CONSTRUCTED UNDER PHASE 1 WORKS

MANHOLE PENSTOKE ON INLET TO TANK

18.3m x 18.3m x 3m DEEP CONCRETE ATTENUATION TANK OR SIMILAR APPROVED

COVER LEVELS SUBJECT TO FINAL LANDSCAPE DESIGN

MANHOLE WITH FLOW CONTROL HYDROBRAKE RESTRICTING FLOW TO 40.46 LITERS PER

PHASE 1 UNDER CONSTRUCTION

PROPOSED LINEAR PARK FOOTPATH CONTINUATION FROM PHASE 1 WORKS

Open Well

Drawing Location: M:\Projects\2302-067 Old Slane Road\Drawings\Waterman Moylan\AutoCAD\Drawings\Phase 2\OSR-WMC-ZZ-DR-C-3202-Drainage-Layouts.dwg
Date: Aug 08, 2024 - 8:49pm